

Lubrication system - exploded view of components

1. Oil pump

With pressure relief valve (12 bar)

Removing and installing → [Chapter](#)

Before installing, check that the two dowel sleeves → [Item](#) for centring oil pump/cylinder block are fitted.

Renew if running surfaces and gears are scored

Tightening torque for oil pump cover to oil pump housing: 10 Nm

2. Chain sprocket for oil pump

Sprocket can only be fitted on oil pump shaft in one position.

3. 22 Nm

4. Drive chain for oil pump

Mark direction of rotation before removing

Check for wear

5. Sealing flange

Apply sealant prior to installing → [Chapter](#)

Renewing crankshaft oil seal on pulley end → [Chapter](#)

6. 15 Nm

7. Chain tensioner

Tighten to 16 Nm

Do not dismantle

Renew only as complete unit

Note installation position

When installing, pre-tension spring and engage

8. Drive chain sprocket for oil pump

Removing and installing → [Chapter](#)

9. Dowel sleeves

2 x

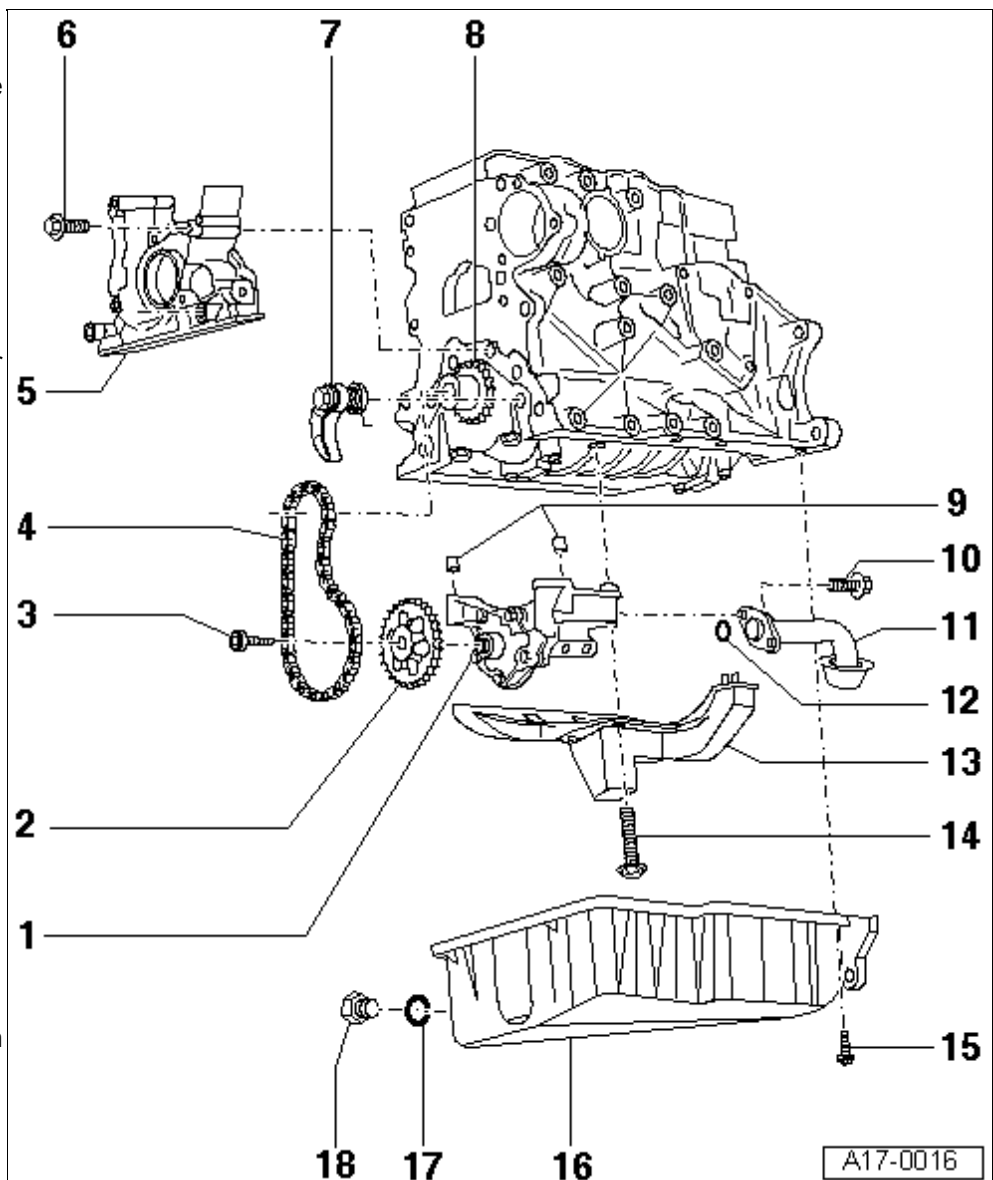

10. **15 Nm**
11. **Intake pipe**

Clean strainer if dirty

12. **O-ring**

Renew

13. **Baffle plate**

14. **16 Nm**

15. **15 Nm**

16. **Sump**

Removing and installing → [Chapter](#)

Install using sealant; sealant → [Parts catalogue](#)

17. **Seal**

Renew

18. **Oil drain plug, 30 Nm**

Oil spray jet and pressure relief valve

1. Oil spray jet (for cooling of pistons)
 2. Bolt with pressure relief valve, 27 Nm
- Opening pressure: 2.5 ... 3.2 bar.

